

Industrial Blow Molds

Tooling Technology and Automation supplies integrated technology solutions for blow molding applications.

Fuel Tank Blow Molds

Tooling Technology & Automation has been producing blow molds for automotive, heavy truck, recreational and lawn tractor fuel tanks for more than 30 years. Let us handle your next fuel tank program from start to finish. (We also produce rotational molds and twin sheet molds for fuel tanks.)

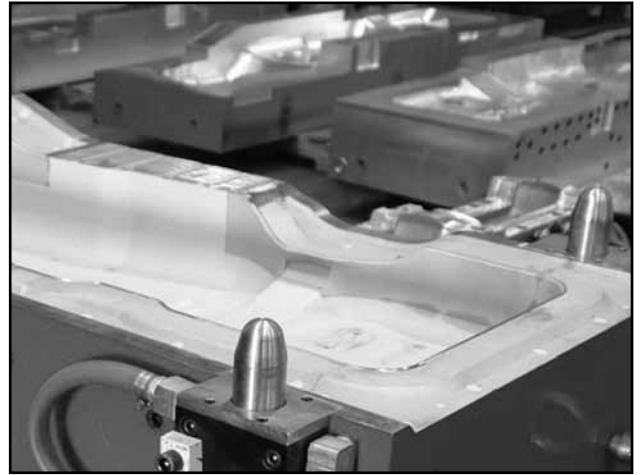
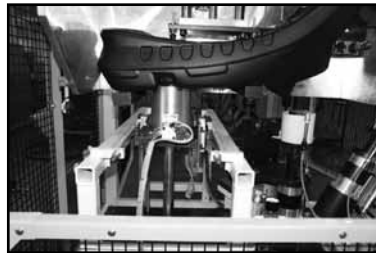
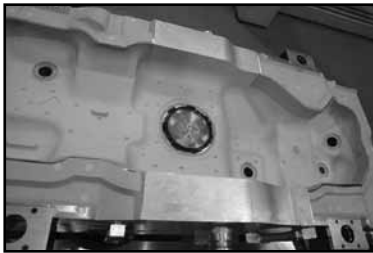

Container Blow Molds

Tooling Technology and Automation offers standard proven designs for a variety of containers that include a 1,000-liter IBC, 55-gallon compress lifting ring, and open head and tight head containers.

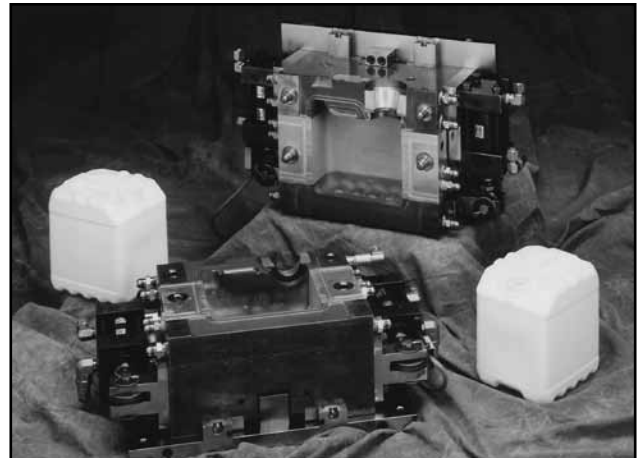

Houseware Blow Molds

Tooling Technology and Automation can produce tooling for a wide range of household products. Tooling for storage bins, garbage cans, tool boxes, field tiles and more. Other such items may include ice coolers, dehumidifiers, water softeners, scapewel, garage door panels, bookshelves, shower base inserts and even flower pots.

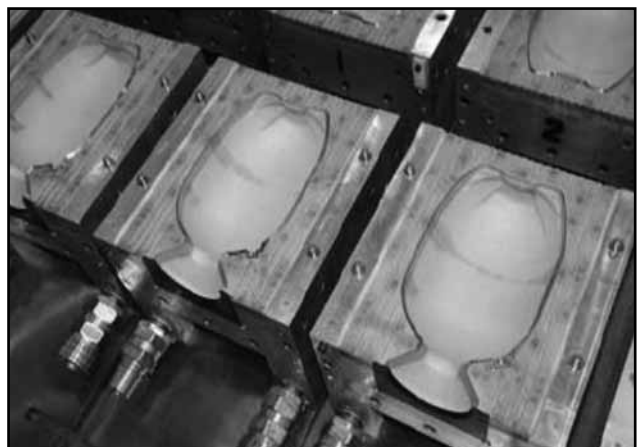

INDUSTRIAL BLOW MOLDS

In-Mold Technology

Tooling Technology and Automation is experienced, qualified and licensed to manufacture Precision Engineered Mechanical knives that can cut or trim the part within the molding cycle. Our In-Mold Technology includes experience engineered retracting blades and core mechanisms for product design flexibility. We have experienced designers and manufacturers of complex retractable unscrew devices. Tooling Technology and Automation can provide mechanisms that are engineered to cut holes in the part during the molding cycle. We are an experienced manufacturer of mechanical devices to deflash parts integrated into the mold.

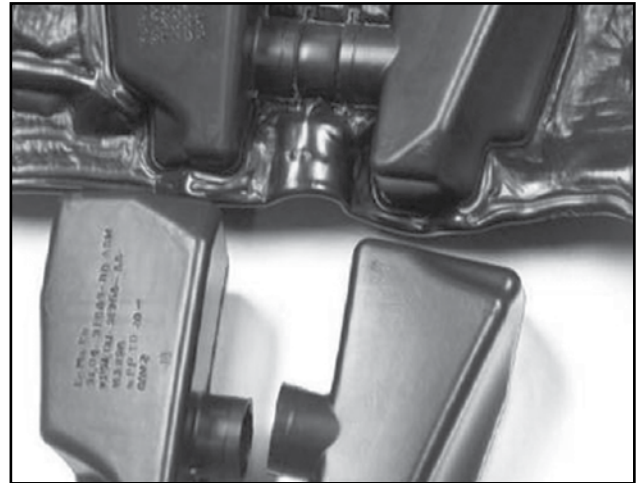

Specialized Tooling

Trapped air blow molding. A parison is clamped by the box frame by trapping air into the box and the mold is closed. Trapped air does not have blowing holes, which is required for certain applications. Few shops have this technical capability and experience. Tooling Technology and Automation is now experienced in manufacturing molds for flashless 3D blow molding systems that have been used for filler-pipe and air-duct production.

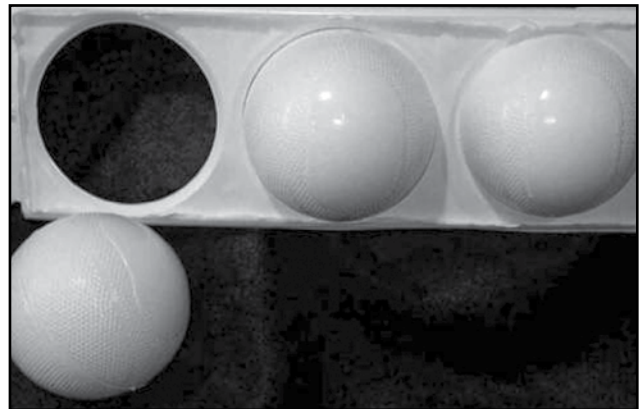

Rotational-to-Blow

While working with the mower manufacturer, Tooling Technology and Automation Engineers were able to design and convert an existing rotational molded tank into a blow molded program very effectively. Using industry experience and knowledge, the team designed a fold up mounting tab versus a conventional injection molded HPW solution. The design focus allowed the processor to start up the program without a custom injection tab saving over \$25k in tooling costs. Furthermore, over the life of the program the savings per part would continue producing the tank more efficiently than the rotational method.

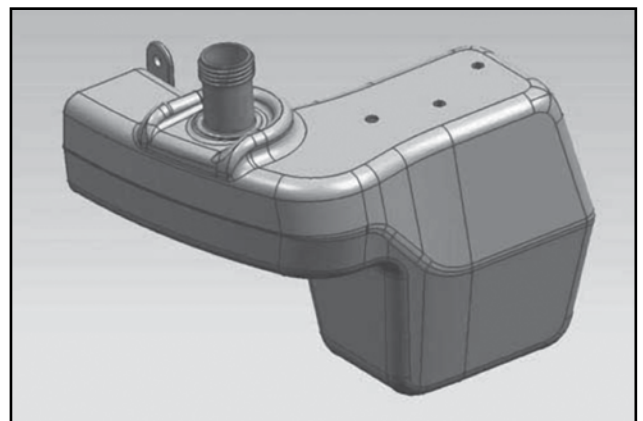

100 Enterprise Drive, Fort Loramie, OH 45845

T: (937) 295-3672 F: (937) 295-3677

www.toolingtechgroup.com

